

DAILY CHECKLIST

DRIVER'S NAME: _____

SIGNED: _____

DATE: _____

HOURLY METER READING: _____

	NO.	CHECK POINTS	CONTENTS	TICK
Safety monitor	1	Function	When key switch is turned on, "MONITORING OK" is displayed	<input type="checkbox"/>
Lamp and Horn	2	Head lamps, Turn signal lamps, Horn	Turn on and off, sound	<input type="checkbox"/> <input type="checkbox"/> <input type="checkbox"/>
Braking system	3	Brake Fluid	Quantity and stain. The quantity of the brake fluid is checked by the safety monitor. If "MONITORING OK" is displayed on the screen when the key switch is on, the quantity is normal	<input type="checkbox"/>
	4	Parking brake	Pulling force of lever and braking force	<input type="checkbox"/>
	5	Brake pedal	Stroke of foot brakepedal and braking force	<input type="checkbox"/>
Steering system	6	Play of steering wheel	Check it is adequately tightened Operating condition	<input type="checkbox"/>
	7	Power steering operation	Operating of all parts	<input type="checkbox"/>
Hydraulic system and Mast	8	Function	Function, any cracks, lubrication	<input type="checkbox"/>
	9	Hydraulic oil	Appropriate quantity	<input type="checkbox"/>
	10	Lift chains	Equal tension of both right & left chains	<input type="checkbox"/>
	11	Oil piping	Oil leakage	<input type="checkbox"/>
Wheel	12	Tyres	Abnormal wearing and / damage	<input type="checkbox"/>
Battery	13	Hub nuts	Securely tightened	<input type="checkbox"/>
	14	Charging	Check battery capacity indicator and specific gravity Plug is securely connected	<input type="checkbox"/> <input type="checkbox"/>
Others	15	Overhead guard, Load backrest	Ensure fitting bolts and nuts are securely tightened	<input type="checkbox"/>
	16	Seat Belt	Damage	<input type="checkbox"/>
	17	Laser Pointer	Focus of beam (optional feature)	<input type="checkbox"/>
	18	Other than above	Any abnormality	<input type="checkbox"/>
			INITIALS:	

INSPECTION PROCEDURE

- ① **Check functions of safety monitor**
[MONITORING OK] is displayed for a few seconds after turning the key switch on at normal condition.

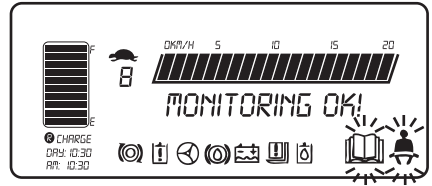

- ② **Check head lamps, tail lamps, turn signal lamps and horn**

Check operation of lamps.
Check sound of horn.

- A: Switch for head lamp and tail lamp
B: Horn button
C: Switch for turn signal lamps
D: Right
E: Left

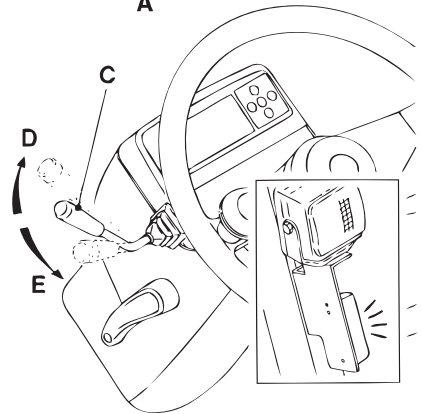
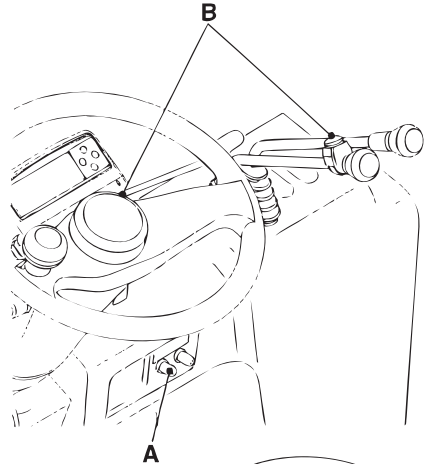

- ③ **Check brake oil**
Check the condition and level of the oil.



- Do not use the conventional brake fluid (such as DOT3).
- Use "Shell Tellas-T15" only.
- Do not use any other types of oil to refill or change

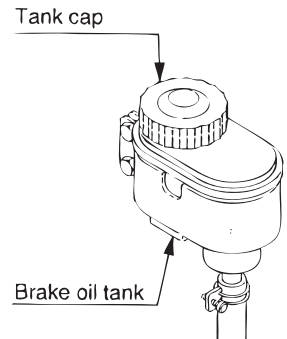

If “REFILL BRAKE OIL” message appears on the display, remove the tank cap and check the level and condition of the brake oil. (This function is optional).

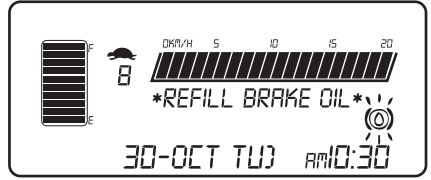

4 **Check parking brake lever**

Pulling the parking lever (A) and check:

- Suitable pulling force (170-220N), (17-22kgf)
- Enough braking force
- No damaged parts

Adjust the pulling force by the adjusting screw (B) at the bottom of the lever.

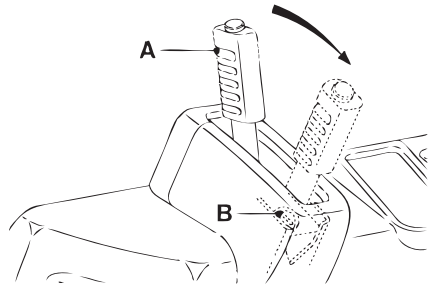

5 **Check foot brake pedal**

Check performance of brake and make sure the stroke of the foot brake pedal (A)

UNIT: mm

Model	B
FB13TCA-18TCA	87 ± 5
FB20TCA	91 ± 5

Proper braking distance without a load is about 2.5m. Adjust if the braking distance is more than the above specs.

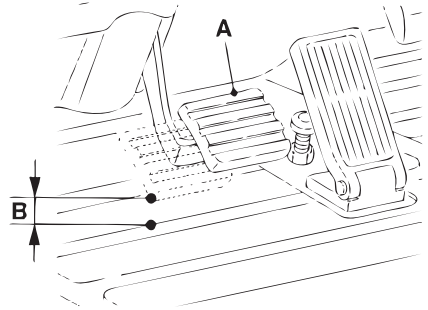

6 **Check play of steering wheel**

Turn the steering wheel to the right and left, and check the free play (50-100mm (A)). The steering wheel moves up and down approximately 2mm (B). This is normal

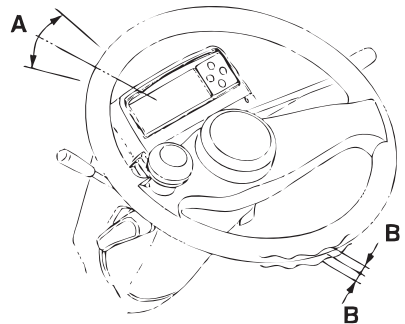

7

Check power steering function

Turn the steering wheel to the right and left to check the steering operation.

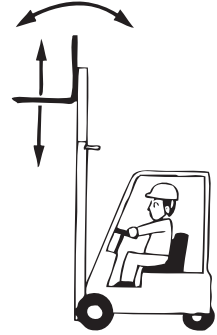

8

Check the hydraulic functions

Check if lifting and tilting operation are smooth.

9

Check the hydraulic oil

Check oil level by using the level gauge (A) when the forks are lowered in the floor. Appropriate oil level is within the range of H and L.

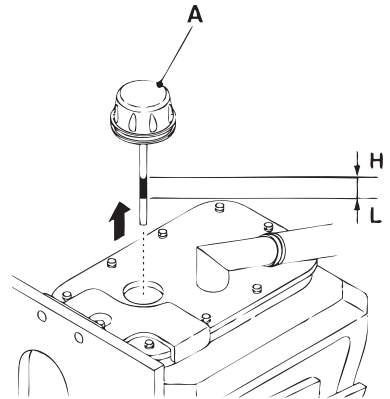

10

Check lift chains

Raise the forks 200-300mm above the floor and check if tension is the same for both right and left chains (A). The mast carriage should be level. If the carriage leans to the right or left, adjust the chain anchor bolts (B).

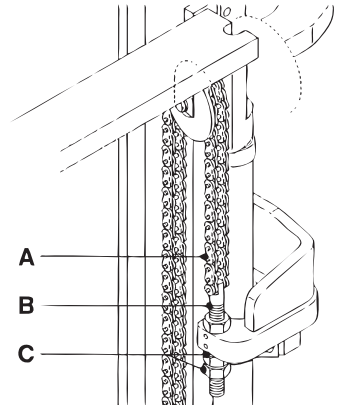

After proper adjustment, tighten up the lock nuts (C) securely.

11

Check oil piping

Check for any oil leakage from the lift cylinders, tilt cylinders and oil piping.

12 Check tyres

Measure the air pressure by using the air pressure gauge.

UNIT: KPa (kgf/cm²)

Applicable model	Front	Rear
FB13TCA-15TCA	900 (9.0)	1 000 (10.0)
FB18TCA	1 000 (10.0)	No puncture
FB20TCA	No puncture	850 (8.5)

After checking air pressure, check that no air is leaking from the valve.

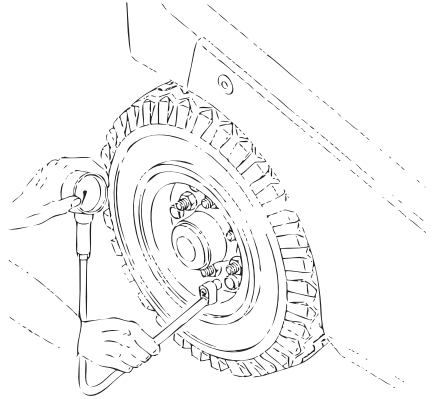

13 Check hub nuts

Check if the hub nuts are secured by tightening them with a torque wrench.

UNIT: N·m (kgf·m)

Applicable model	Front	Rear
FB13TCA-18TCA	216-264 (22-27)	89-108 (9-11)
FB20TCA	216-264 (22-27)	216-264 (22-27)

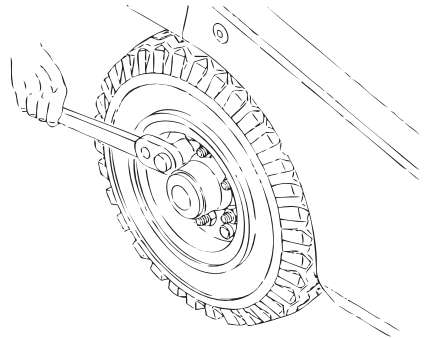

14 Check charging

Measure the specific gravity of battery. When it shows 1.260-1.280 at 20°C conversion, the battery is fully charged.

15 Check overhead guard and load backrest

Check if all fitting bolts and nuts are correctly secured and torqued.

16 Check seat belt

Check any damages on the tang (A) and buckle (B).

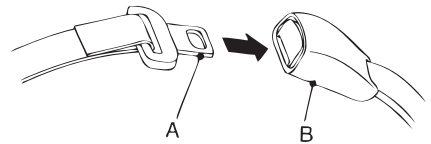

17 Check beam of laser pointer (optional)

If optional laser pointer is equipped, irradiate the beam and check it's focus.

A: Line type

B: Point type

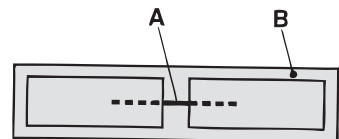

18 Other

Check for any other abnormalities.